

LEGEND

- A" RESIDENTIAL (REFER TO BUILDING ZONE ORDINANCE FOR LOT AREA REQUIREMENTS)
- A-1" RESIDENTIAL
- B" RESIDENTIAL

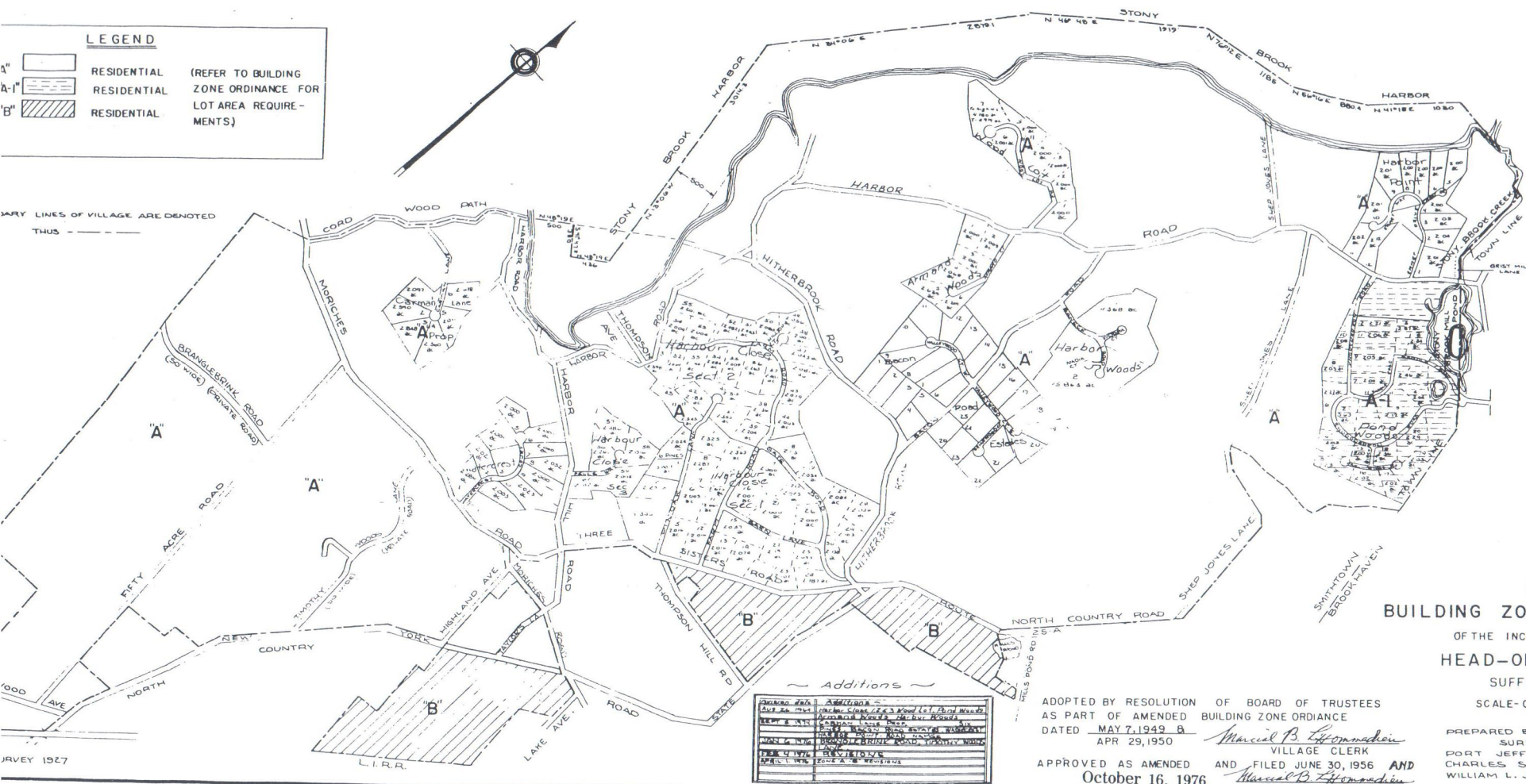

BOUNDARY LINES OF VILLAGE ARE DENOTED BY DASHED LINES



~ Additions ~

Original Date	Additions
1949	...
1950	...
1956	...
1976	...

REVISED BUILDING ZONE ORDINANCE

OF THE INCORPORATED VILLAGE OF HEAD-OF-THE-HARBOR, SUFFOLK CO. N.Y.

SCALE-ONE INCH= 600 FEET

ADOPTED BY RESOLUTION OF BOARD OF TRUSTEES AS PART OF AMENDED BUILDING ZONE ORDINANCE DATED MAY 7, 1949 AND APR 29, 1950

Marcel B. Lippman
VILLAGE CLERK

APPROVED AS AMENDED AND FILED JUNE 30, 1956 AND OCTOBER 16, 1976

Marcel B. Lippman
VILLAGE CLERK

PREPARED BY HAWKINS, WEBB, JAEGER SURVEYING & ENGINEERS, PORT JEFFERSON, SUFFOLK COUNTY, CHARLES S. WEBB JR. N.Y.S. LIC. NO. 10000, WILLIAM L. JAEGER II N.Y.S. LIC. NO. 10000